

Model 009 Cartridge Circulator

The High Velocity Series TACO 009 Cartridge Circulator is designed for quiet, efficient operation in higher-head/lower-flow applications for Hydronic heating, Radiant In-Floor/Panel heating, Solar heating, Heat Recovery, and Domestic Water Recirculation systems. Its unique field-serviceable cartridge contains all moving parts. Replacing the cartridge rebuilds the circulator. With no Mechanical Seal, the self-lubricating, maintenance free design provides unmatched reliability. Available in Cast Iron or Bronze Construction.

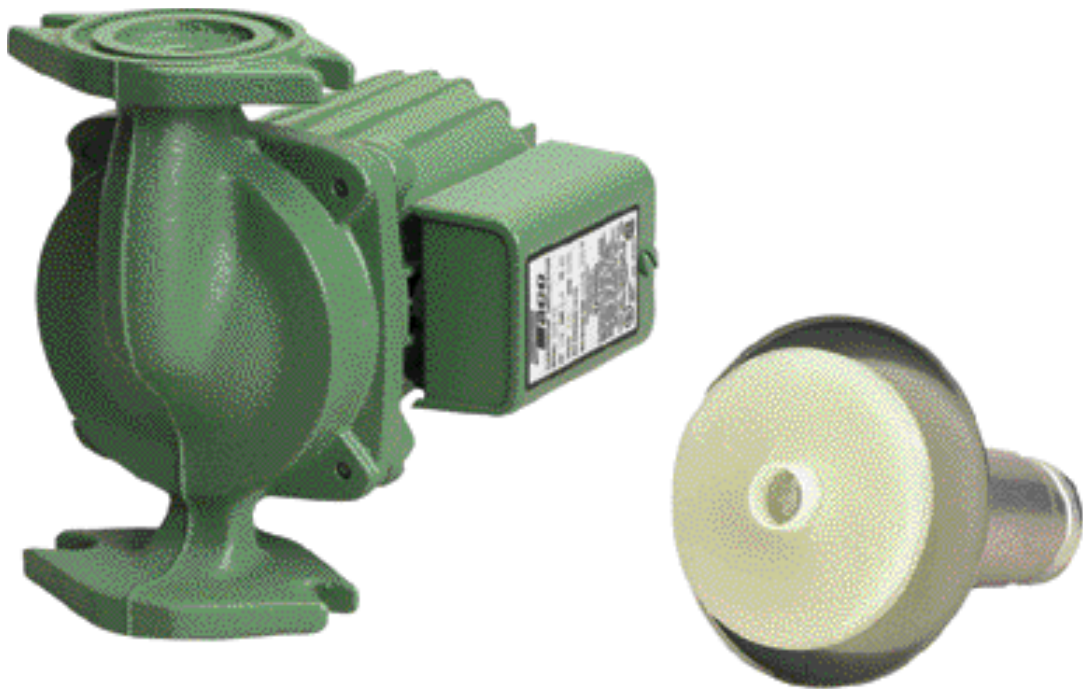

WATER CIRCULATION, FLOW CONTROL, AIR ELIMINATION, FLOW MEASUREMENT/ BALANCING, ELECTRONIC CONTROLS

**Do it once.
Do it right.** 

Submittal Data Information Model 009 Cartridge Circulator

Features

- Standard High Capacity Output-Compact Design
- Quiet, Efficient Operation
- Direct Drive-Low Power Consumption
- Unique Replaceable Cartridge Design-Field Serviceable
- Self Lubricating
- No Mechanical Seal
- Unmatched Reliability-Maintenance Free
- Universal Flange to Flange Dimensions
- Cast Iron or Bronze Construction

Materials of Construction

Casing (Volute): Cast Iron or Bronze
 Stator Housing: Aluminum
 Cartridge: Stainless Steel
 Impeller: Non-Metallic
 Shaft: Ceramic
 Bearings: Carbon
 O-Ring & Gaskets: EPDM

Model Nomenclature

F – Cast Iron, Flanged
 BF – Bronze, Flanged
Variations:
 Z – Zoning Circulator
 J – Bronze Cartridge with Cast Iron Casing

Performance Data

Flow Range: 0 – 8 GPM
 Head Range: 0 – 34 Feet
 Minimum Fluid Temperature: 40°F (4°C)
 Maximum Fluid Temperature: 230°F (110°C)
 Maximum Working Pressure: 125 psi
 Minimum Required Inlet Pressure: 14 psi
 Connection Sizes: 3/4", 1", 1-1/4", 1-1/2" Flanged



UL & CSA Listed
FOR INDOOR USE ONLY

Application

The Taco 009 is designed for a wide range of Residential and Light Commercial higher-head/lower-flow water circulating applications. Typical uses include Hydronic heating, Radiant In-Floor/Panel heating and closed-loop Solar heating systems. The Bronze 009 can be used in higher-head/lower-flow Heat Recovery, open-loop Solar heating and Light Commercial Domestic Water Recirculation systems. The unique replaceable cartridge contains all of the moving parts and allows for easy service, instead of replacing the entire circulator. Compact, direct-drive, low power consumption design is ideal for high-efficiency jobs.

Pump Dimensions & Weight

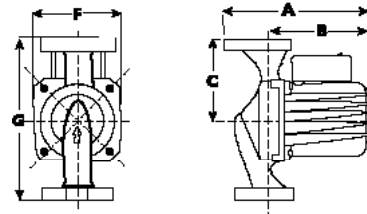
Model	Casing	A		B		C		D		F		G		Ship Wt.	
		in.	mm	in.	mm	in.	mm	in.	mm	in.	mm	in.	mm	lbs.	Kg
009-F5	Cast Iron	7	178	5-11/16	144	3-3/16	81	3-5/16	84	4-1/8	105	6-3/8	162	9.5	4.3
009-BF5	Bronze	7	178	5-11/16	144	3-3/16	81	3-5/16	84	4-1/8	105	6-3/8	162	9.5	4.3



Mounting Positions

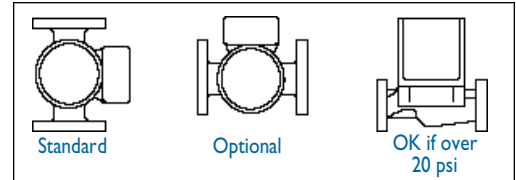

Electrical Data

Model	Volts	Hz	Ph	Amps	RPM	HP
009-F5	115	60	1	1.40	3250	1/8
009-BF5	115	60	1	1.40	3250	1/8
Motor Type	Permanent Split Capacitor Impedance Protected					
Motor Options	220/50/1, 220/60/1, 230/60/1, 100/110/50/60/1					

Flange Orientation

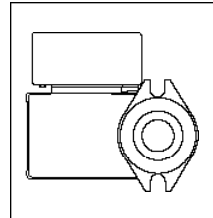

Performance Field - 60Hz

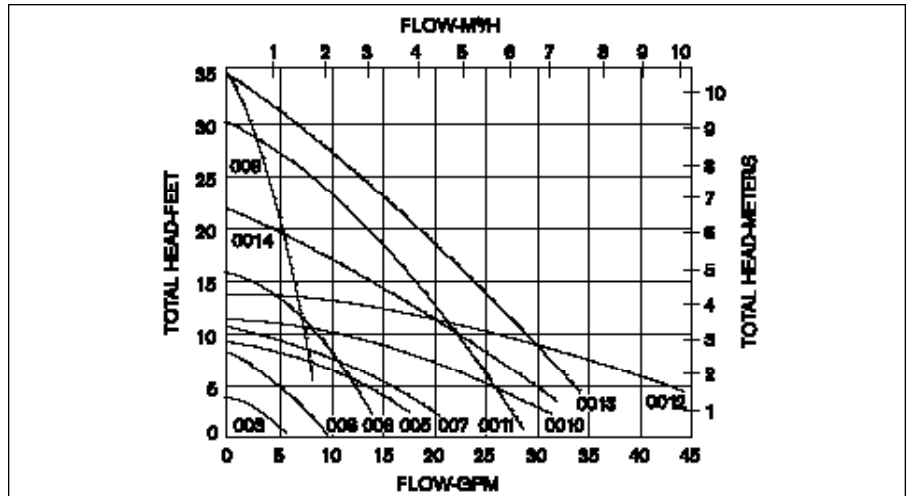

WATER CIRCULATION, FLOW CONTROL, AIR ELIMINATION, FLOW MEASUREMENT/ BALANCING, ELECTRONIC CONTROLS

Do it once.
 Do it right. 