

### Model 0011 Cartridge Circulator

The High Velocity series TACO 0011 Cartridge Circulator is designed for high head / medium flow applications in Large Residential / Light Commercial Hydronic heating, Radiant heating, and Chilled Water cooling systems. The unique ACB anti-condensate baffle with ambient air flow prevents the build up of condensate on the motor windings when pumping chilled water. Its unique field-serviceable cartridge contains all moving parts. Replacing the cartridge rebuilds the circulator. With no Mechanical Seal, the self-lubricating, maintenance free design provides unmatched reliability. Compact and lightweight, with excellent performance characteristics, the 0011 is ideal for installations where space is a premium. Available in Cast Iron or Bronze Construction.

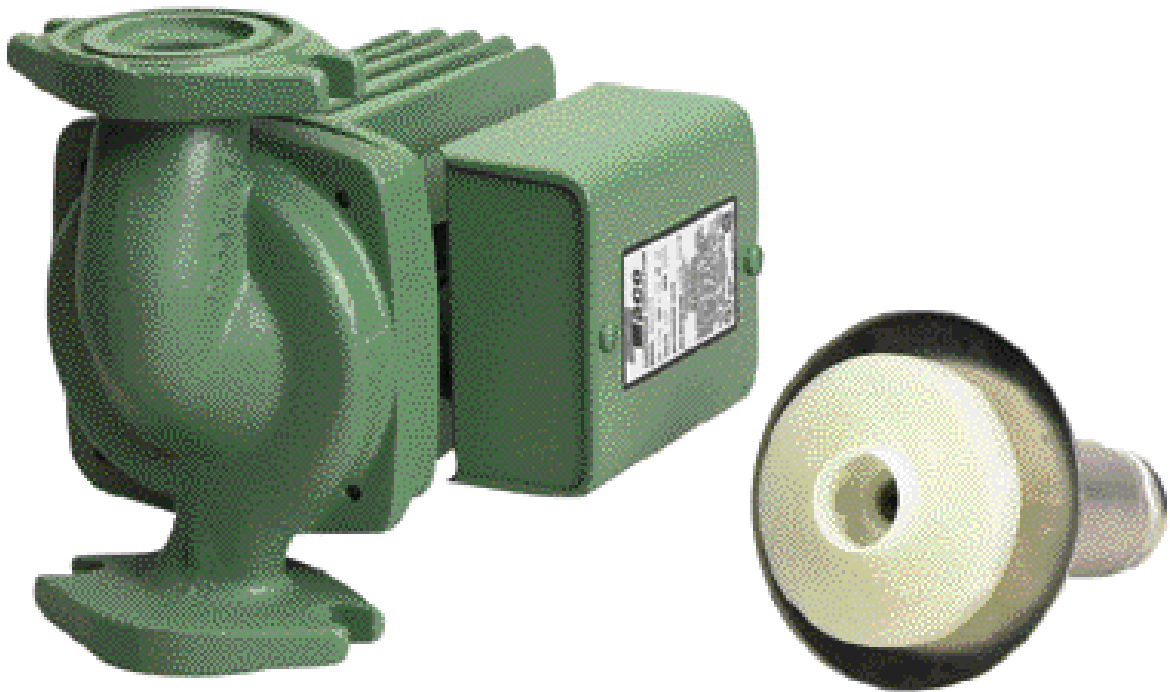

WATER CIRCULATION, FLOW CONTROL, AIR ELIMINATION, FLOW MEASUREMENT/BALANCING, ELECTRONIC CONTROLS

Do it once.  
Do it right. **Taco**

# Submittal Data Information Model 0011 Cartridge Circulator

## Features

- Exclusive ACB Anti-Condensate Baffle with Ambient Air Flow- Protects Motor Windings against Condensate Buildup
- High Velocity Performance -Compact Design
- Quiet, Efficient Operation
- Direct Drive-Low Power Consumption
- Unique Replaceable Cartridge Design-Field Serviceable
- Self Lubricating
- No Mechanical Seal
- Unmatched Reliability-Maintenance Free
- Universal Flange to Flange Dimensions
- Cast Iron or Bronze Construction

## Materials of Construction

Casing (Volute):	Cast Iron or Bronze
Stator Housing:	Aluminum
Cartridge:	Stainless Steel
Impeller:	Non-Metallic
Shaft:	Ceramic
Bearings:	Carbon
O-Ring & Gaskets:	EPDM

## Model Nomenclature

- F – Cast Iron, Flanged  
 BF – Bronze, Flanged
- Variations:**
- Z – Zoning Circulator  
 J – Bronze Cartridge with Cast Iron Casing

## Performance Data

- Flow Range: 0 – 28 GPM  
 Head Range: 0 – 30 Feet  
 Minimum Fluid Temperature: 40°F (4°C)  
 Maximum Fluid Temperature: 230°F (110°C)  
 Maximum Working Pressure: 125 psi  
 Minimum Required Inlet Pressure: 14 psi  
 Connection Sizes: 3/4", 1", 1-1/4", 1-1/2"



**UL & CSA Listed  
 FOR INDOOR USE ONLY**

## Application

The TACO 0011 is specifically designed for high head / medium flow applications in Large Residential / Light Commercial closed loop Hydronic heating and Chilled Water cooling systems. Ideal for high pressure drop Boilers, Fan Coil units, Heat Exchangers, large Radiant Heating and Heat Recovery/Geothermal systems. The Bronze 0011 can be used on open loop systems. The unique replaceable cartridge contains all of the moving parts and allows for easy service instead of replacing the entire circulator. Universal flange to flange dimensions and orientation allows the 0011 to easily replace other models. Compact, Low Power Consumption design makes it ideal for high-efficiency jobs.

## Pump Dimensions & Weight

Model	Casing	A		B		C		D		F		G		Ship lbs.	Wt. Kg
		in.	mm	in.	mm	in.	mm	in.	mm	in.	mm	in.	mm		
0011-F4	Cast Iron	7-5/8	194	6-7/32	158	3-1/4	82	3-3/4	95	6	152	6-1/2	165	12.0	5.5
0011-BF4	Bronze	7-5/8	194	6-7/32	158	3-1/4	82	3-3/4	95	6	152	6-1/2	165	12.0	5.5

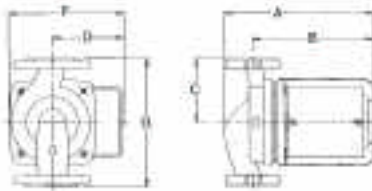

## Mounting Positions

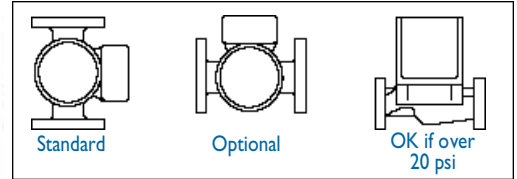

## Electrical Data

Model	Volts	Hz	Ph	Amps	RPM	HP
0011-F4	115	60	1	1.76	3250	1/8
0011-BF4	115	60	1	1.76	3250	1/8
Motor Type	Permanent Split Capacitor Impedance Protected					
Motor Options	220/50/1, 220/60/1, 230/60/1, 100/110/50/60/1					

## Flange Orientation

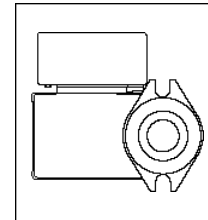

## Performance Field - 60Hz

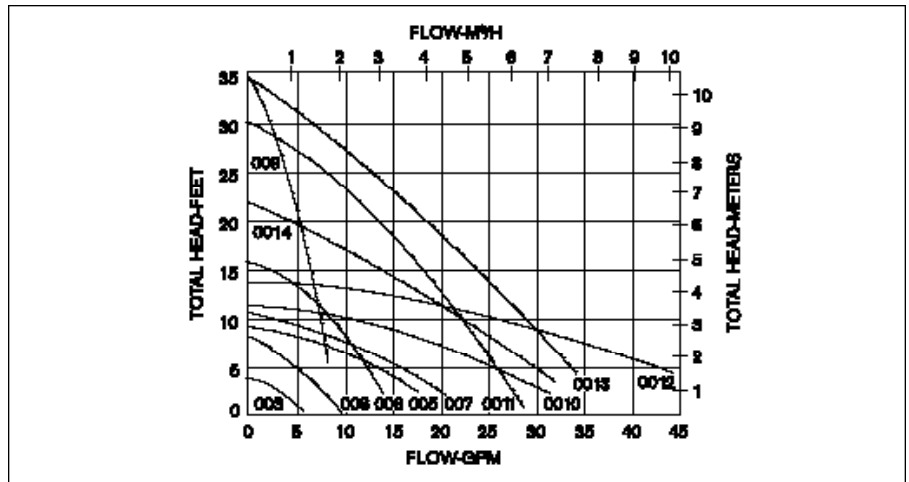

WATER CIRCULATION, FLOW CONTROL, AIR ELIMINATION, FLOW MEASUREMENT/ BALANCING, ELECTRONIC CONTROLS

